

Cabin Air Filter Installation Instructions

Interior ventilation filter is located behind the glove box door inside filter housing.

1. Open glove box door. Squeeze in on damper rod locking tab and slide rod off of mount. (See Figure 1)
2. Push in on both sides of the glove box door to release from stop latches and allow the door to swing downwards. (See Figure 2)
3. Reach into cavity and grasp both sides of the filter housing cover tabs and unlock tabs by pulling towards you. (See Figure 3)
4. Slide filter out of housing.
5. Install in the reverse order of removal.

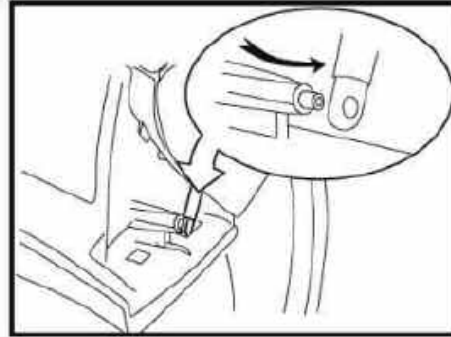

Figure 1

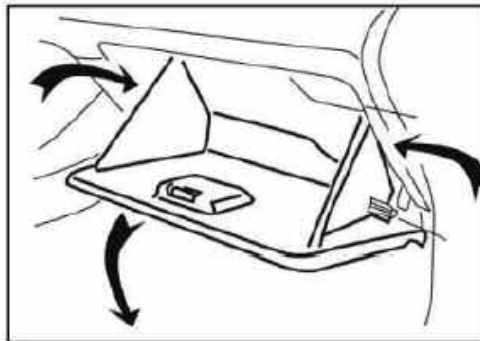

Figure 2

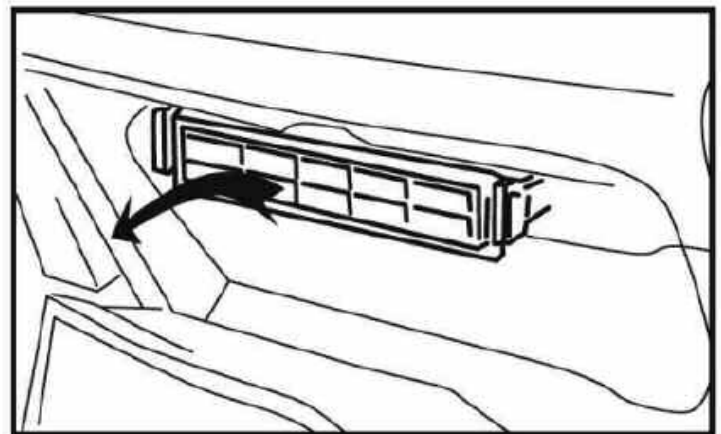

Figure 3

Approximate install time: 10 minutes

atp

professional auto parts®

1300 Pratt Boulevard
Elk Grove Village, Illinois 60007
Tech Help Line: 1-800-528-6695
www.atp-inc.com