

Cabin Air Filter Installation Instructions

Interior ventilation filter is located inside filter housing, behind the glove compartment door.

1. Open the glove box door.
2. Push in at each side of the glove box door to lower it until it hangs straight down. (See Figure 1)
3. Remove filter housing cover. (See Figure 2)
4. Slide filter out towards you and replace in the reverse order of removal. (See Figure 3)

Approximate Installation Time:
10 Minutes

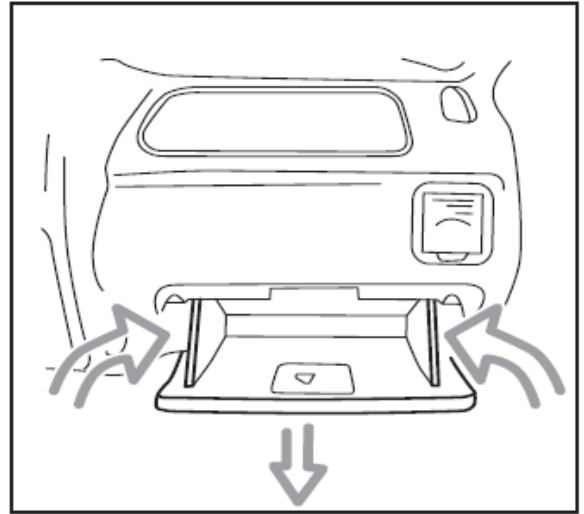

Figure 1

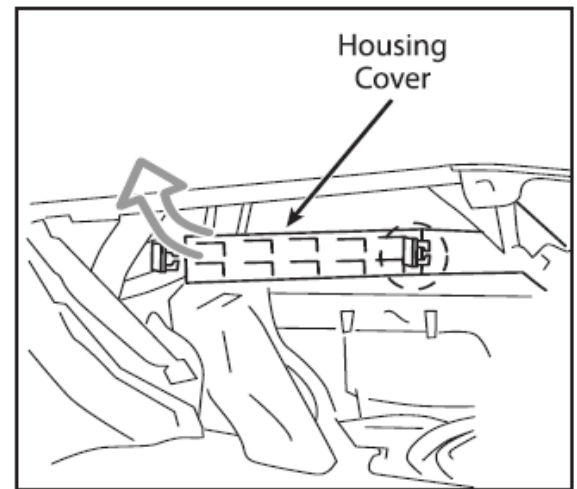

Figure 2

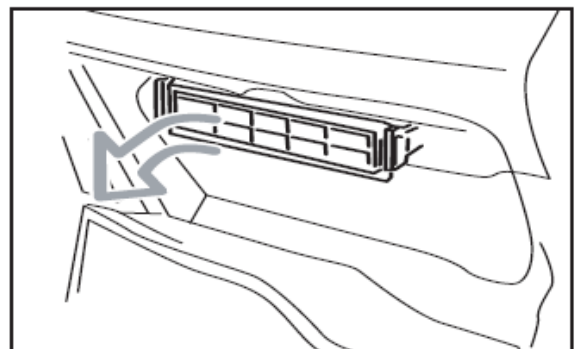

Figure 3

atp
professional auto parts®

1300 Pratt Boulevard
Elk Grove Village, Illinois 60007
Tech Help Line: 1-800-528-6695
www.atp-inc.com