

Installation Instructions for Gear Shift Cables

1

Align the metal pin of the upper section with the metal coupling of the lower section.

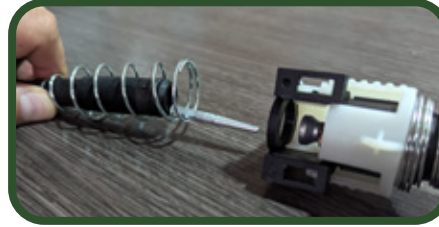

2

Insert the pin into the coupling and ensure it clicks with the Seeger pin, securing both cables together and allowing for axial movement between the two sections.

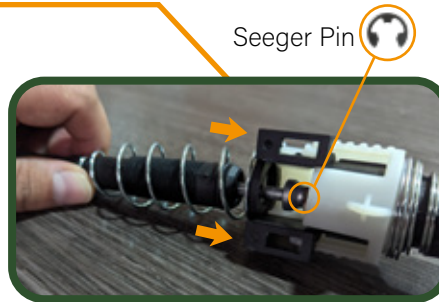

3

Place the serrated plastic terminal of the upper section between the plastic terminal of the lower section, ensuring that the serrated terminal on the upper part is equipped with an O-ring adjustment.

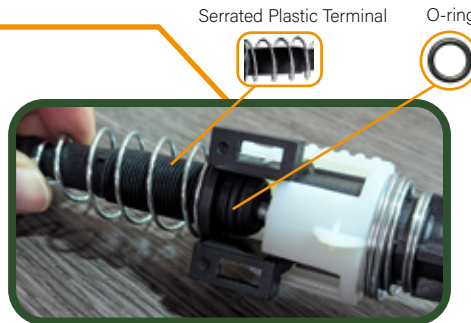

4

Once both sections are assembled, adjust the cable length at the proper point to ensure optimal operation. Then, lower the white locking mechanism to secure the sections in place. After this, slide the white protector over the lock.

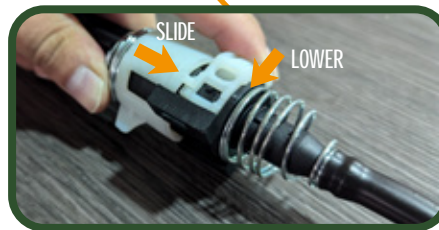

5

Ensure that all connections and assemblies are properly secured and pinned before proceeding with the installation in the vehicle.

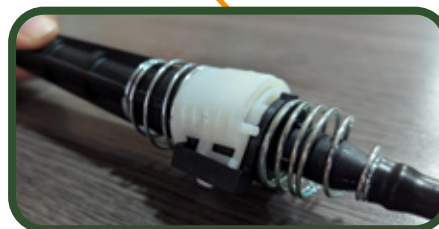

UPPER CABLE

LOWER CABLE

