

Cabin Air Filter Installation Instructions

Interior ventilation filter is located inside filter housing, behind the glove box door.

1. Open the glove box door.
2. At the right side of the glove box door, slide off connecting rod damper. (See Figure 1)
3. Push in on each side of the glove box door to release tabs, allow the glove box door to swing down. (See Figure 2)
4. Remove filter housing cover and slide filter out towards you. (See Figure 3)
5. Install in the reverse order of removal.

Approximate Installation Time: 10 Minutes

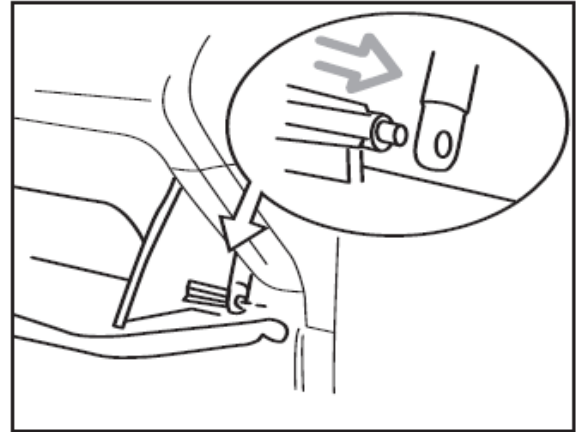

Figure 1

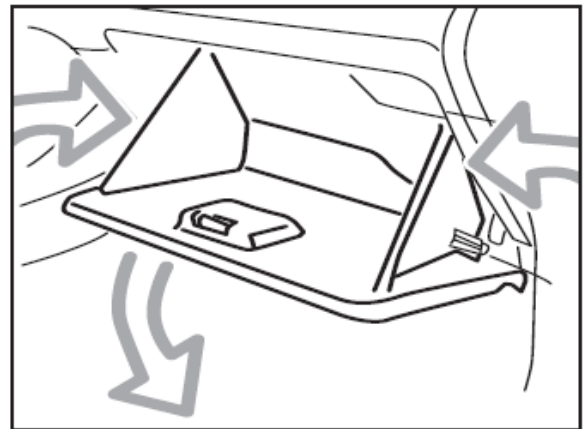

Figure 2

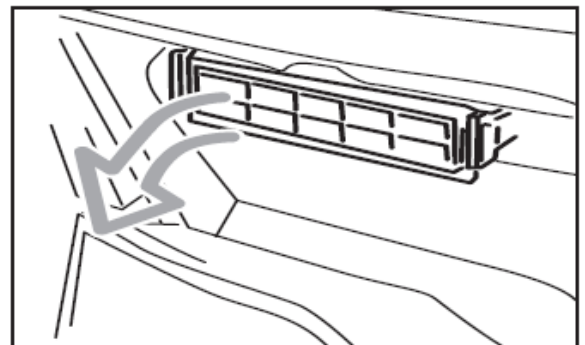

Figure 3

atp

professional auto parts®

1300 Pratt Boulevard
Elk Grove Village, Illinois 60007
Tech Help Line: 1-800-528-6695
www.atp-inc.com